

FULLY HEATED,
COOLED &
SPRINKLED

01/12/2021

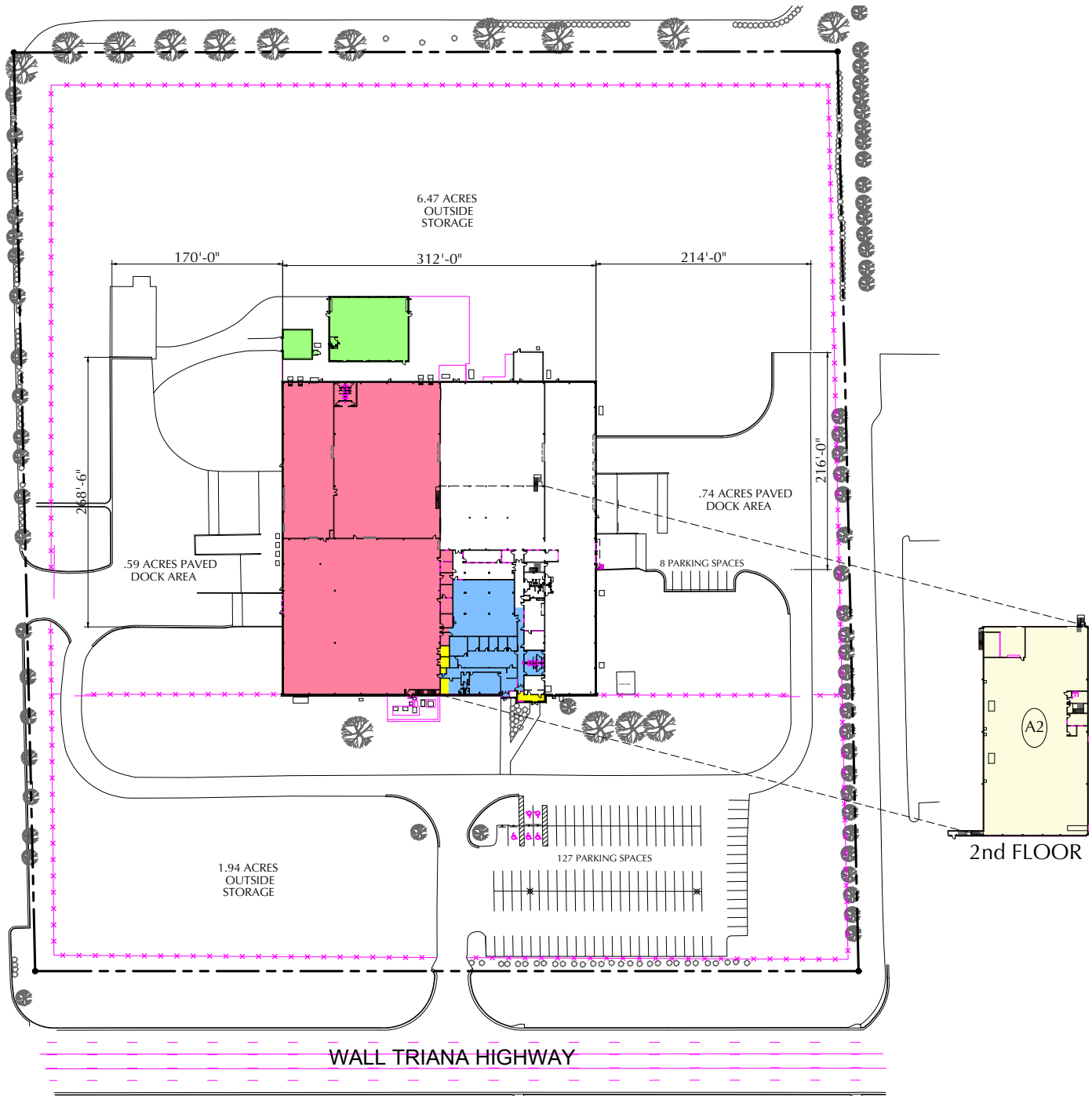

SITE PLAN

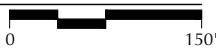

CONTACT:
Laurel Bailey
Industrial Properties of the South
9668 Madison Blvd. - Suite 100
Madison, AL 35758-9160
p: 256-461-7482
e: l.bailey@industrialproperties.net
www.industrialpropertiesofthesouth.com

- AVAILABLE - APPROX. 6,115 S.F.
- MEZZANINE - APPROX. 21,415 S.F.
- LEASED - APPROX. 39,281 S.F.
- AVAILABLE - APPROX. 50,120 S.F.
- AVAILABLE - APPROX. 8,638 S.F.
- COMMON - APPROX. 618 S.F.



WOODMONT PARK, LLC
2845 Wall Triana Hwy.
Huntsville, Alabama 35824

NOLA VANPEURSEM
ARCHITECTS, PC
NVParchitects.com