

FULLY HEATED,
COOLED &
SPRINKLED

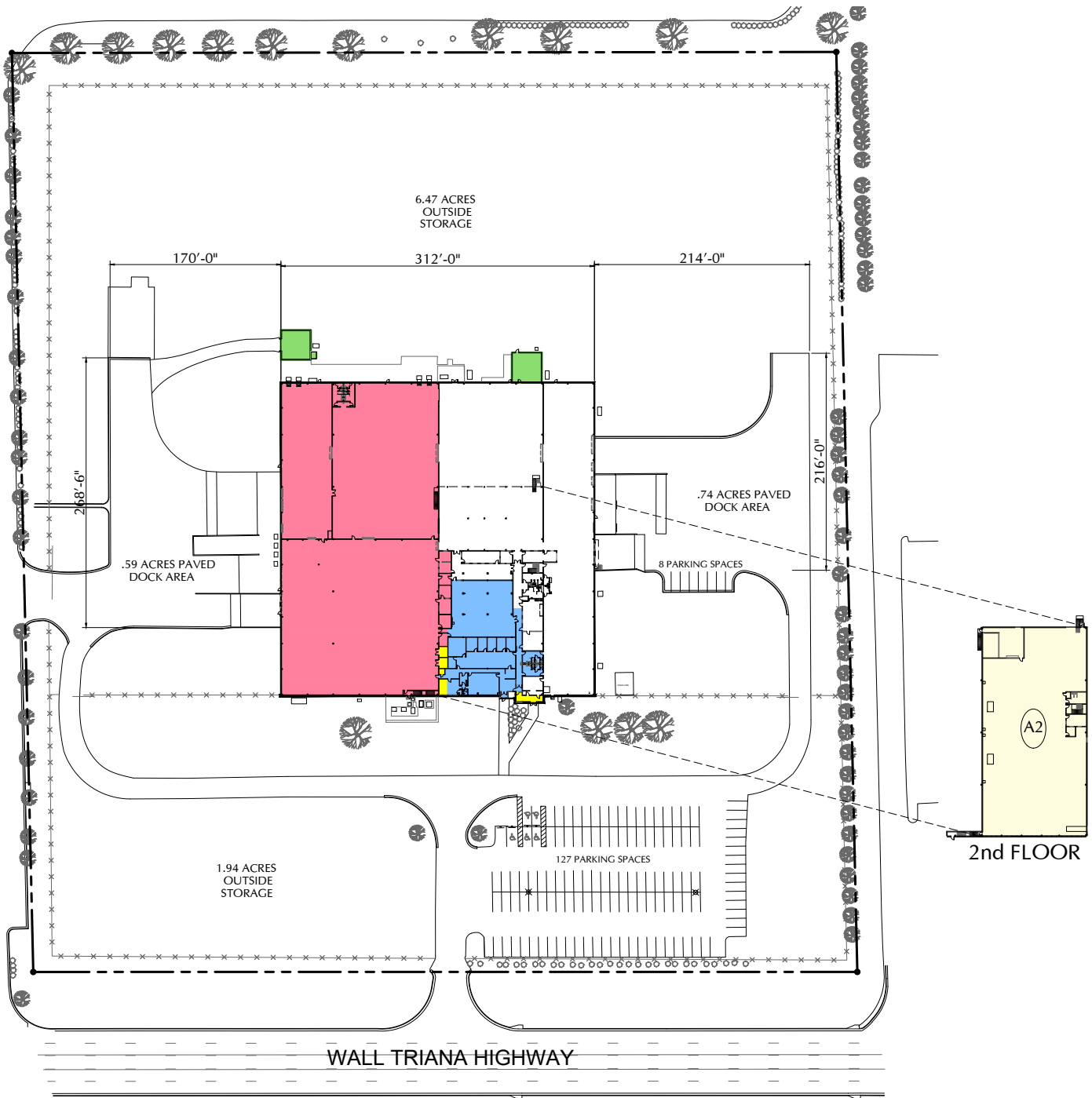

SITE PLAN



CONTACT:
 Laurel Bailey
 Industrial Properties of the South
 9668 Madison Blvd. - Suite 100
 Madison, AL 35758-9160
 p: 256-461-7482
 e: l.bailey@industrialproperties.net
 www.industrialpropertiesofthesouth.com

- MEZZANINE
- LEASED
- APPROX. 50,120 S.F.
- AVAILABLE - APPROX. 8,638 S.F.
- COMMON - APPROX. 618 S.F.



WOODMONT PARK, LLC
 2845 Wall Triana Hwy.
 Huntsville, Alabama 35824

NOLA VANPEURSEM
 ARCHITECTS, PC
 NVParchitects.com